

SCALE 1:1

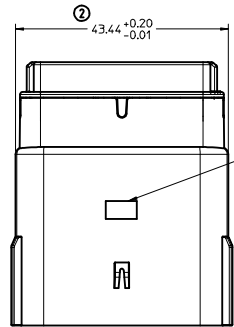

OPTIONAL TRACEABILITY INFORMATION LOCATED IN THIS AREA

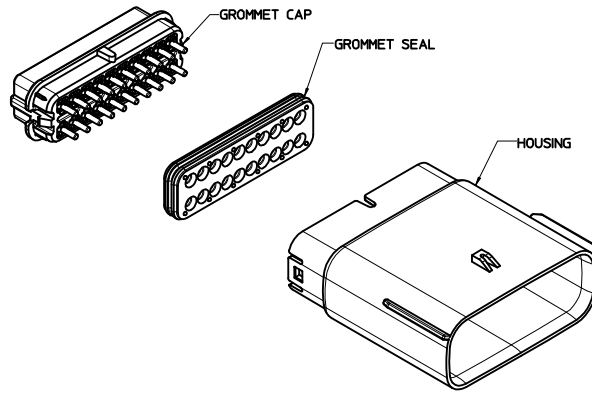
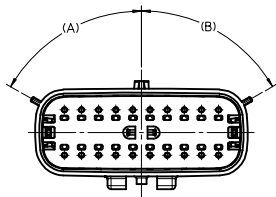
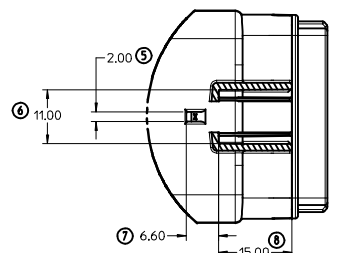
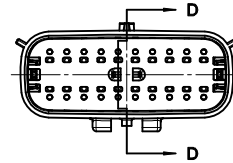
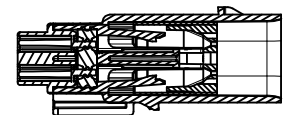
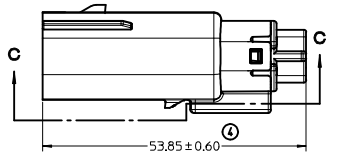
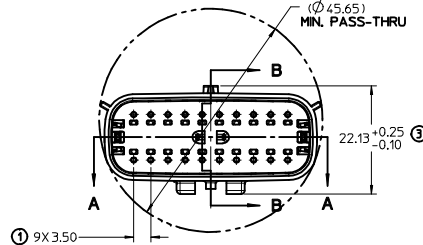
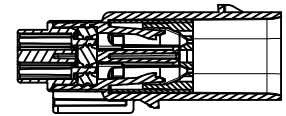
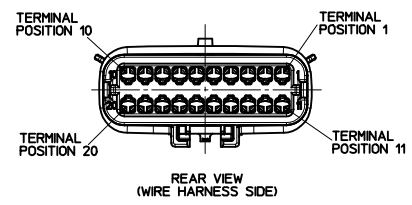
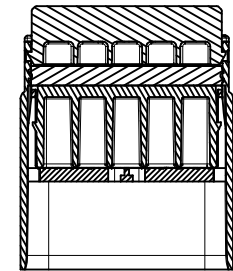

KEYING OPTION
SEE TABLE
SCALE 2:1

NOTES: UNLESS OTHERWISE STATED

- DESIGNED TO MATE WITH RECEPTACLE HOUSING ASSEMBLY SPECIFIED IN MOLEX CHARTED DRAWING SD-33472-201.
- ASSEMBLY SHIPPED WITH BLADE INSERT IN PRE-LOCKED POSITION (SEE SECTION D-D PRE-LOCK). UPON FULL TERMINAL ASSEMBLY EACH BLADE INSERT MUST BE SNAPPED INTO ITS FINAL-LOCK POSITION. FOR TO MOVE INSERT FROM FINAL TO PRE-LOCK POSITION: 75 N MAX
- FOR BLADE TERMINALS TO BE USED WITH THIS ASSEMBLY. SEE DRAWING SD-33000-001.
- SYSTEM TO BE USED WITH WIRE WITHIN DIAMETER RANGE OF 1.5mm TO 2.5mm.
- MATERIAL: SPS/NYLON BLEND, 20% GLASS FILLED.
- SHALL CONFORM TO PACKAGING SPECIFICATION PK-30907-896.
- SHALL CONFORM TO PRODUCT SPECIFICATION PS-33472-000.

REDRAWN IEC NO: UAU2009-0513 DRAWN BY: DRINKSVERZYL 2008/11/20 CHECKED BY: CHYKORRFFIHS 2008/11/20 APPROVED BY: APPR:VKOSHY 2008/11/20 REV: N	QUALITY SYMBOLS	GENERAL TOLERANCES (UNLESS SPECIFIED)	DIMENSION STYLE	SCALE	DESIGN UNITS	THIRD ANGLE PROJECTION
	▽=0 ▽=0	mm INCH 4 PLACES ± --- ± --- 3 PLACES ± 0.10 ± --- 2 PLACES ± 0.3 ± --- 1 PLACE ± 0.3 ± --- ANGULAR ± 3°	MM ONLY	2:1	METRIC	☉ THIRD ANGLE PROJECTION
	DRAFT WHERE APPLICABLE MUST REMAIN WITHIN DIMENSIONS	DRAWN BY: DGRIFFIHS 06-17-03 CHECKED BY: DATE: 06-17-03 APPROVED BY: DATE: 06-17-03 DGRIFFIHS	MATERIAL NO: SEE TABLE	DOCUMENT NO: SD-33482-201	TITLE: MX150 BLADE CONNECTOR ASSEMBLY 2 ROW SEALED, 20 WAY	
			MOLEX INCORPORATED	SHEET NO: 1 OF 2		

ASSEMBLY PART NUMBER	COLOR	KEYING OPTION	DIMENSIONS		CAVITY TYPE & STATUS (X = PLUGGED)																			
			A	B	1	2	3	4	5	6	7	8	9	10	11	12	13	14	15	16	17	18	19	20
33482-2001	BLACK	A	60°	60°																				
33482-2002	LT.GRAY	B	25°	60°																				
33482-2003	BROWN	C	60°	25°																				
33482-2004	GREEN	D	25°	25°																				
33482-2005	CUSTOM	TBD																						
33482-2006	BLACK	A	60°	60°																				X
33482-2007	BLACK	A	60°	60°										X										
33482-2008	BLACK	A	60°	60°					X	X	X	X				X	X	X	X					
33482-2009	BLACK	A	60°	60°										X				X						
33482-2010	BLACK	A	60°	60°										X	X	X			X					X
33482-2011	BLACK	A	60°	60°	X	X								X	X	X								X
33482-2012	BLACK	A	60°	60°	X	X								X	X	X								X
33482-2013	BLACK	A	60°	60°	X	X								X	X	X	X	X						X
33482-2014	BLACK	A	60°	60°			X	X	X											X				X
33482-2015	BLACK	A	60°	60°			X	X	X											X				X
33482-2016	BLACK	A	60°	60°		X															X	X	X	X
33482-2017	BLACK	A	60°	60°																	X	X	X	X
33482-2018	BLACK	A	60°	60°										X		X	X	X				X		X
33482-2019	BLACK	A	60°	60°			X	X								X				X		X		X
33482-2020	BLACK	A	60°	60°			X	X	X							X				X	X	X	X	X
33482-2021	BLACK	A	60°	60°	X	X	X	X	X						X					X	X	X	X	X
33482-2022	BLACK	A	60°	60°			X	X							X					X		X	X	X
33482-2023	BLACK	A	60°	60°										X	X	X				X	X	X	X	X
33482-2024	BLACK	A	60°	60°																X	X	X		X

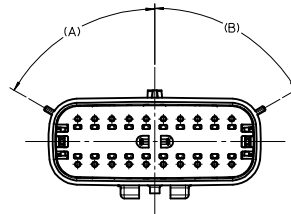

KEYING OPTION
SEE TABLE
SCALE 2:1

ENTER DESCRIPTION IEC NO. UAU2009-0513 DRAWN BY: CHYKORRFFIHS 2008/11/20 CHECKED BY: APPR:VKOSHY 2008/11/20 REV DESCRIPTION	QUALITY SYMBOLS	GENERAL TOLERANCES (UNLESS SPECIFIED)	DIMENSION STYLE	SCALE	DESIGN UNITS	THIRD ANGLE PROJECTION
	▼=0 ▽=0	mm INCH 4 PLACES ± --- ± --- 3 PLACES ± --- ± --- 2 PLACES ± 0.10 ± --- 1 PLACE ± 0.3 ± --- ANGULAR ± 3 °	MM ONLY 2:1 METRIC	DRAWN BY: DGRIFFIHS 06-17-03 CHECKED BY: DGRIFFIHS 06-17-03 APPROVED BY: DGRIFFIHS 06-17-03	DATE: 06-17-03 DATE: 06-17-03 DATE: 06-17-03	TITLE: MX150 BLADE CONNECTOR ASSEMBLY 2 ROW SEALED, 20 WAY MOLEX INCORPORATED
DRAFT WHERE APPLICABLE MUST REMAIN WITHIN DIMENSIONS			MATERIAL NO. 999999999		DOCUMENT NO. SD-33482-201	
THIS DRAWING CONTAINS INFORMATION THAT IS PROPRIETARY TO MOLEX INCORPORATED AND SHOULD NOT BE USED WITHOUT WRITTEN PERMISSION						